

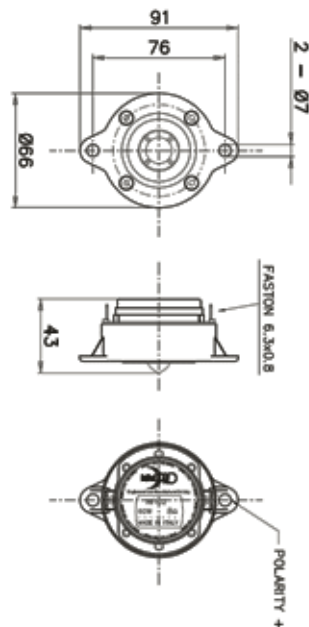

HF102 Compression Driver



NOMINAL SPECIFICATIONS

Throat Diameter	25,4 mm (1 in)
Overall Diameter	91 mm (3.58 in)
180° Mounting Holes Diameter (2xM6)	76 mm (2.99 in)
Depth	43 mm (1.69 in)
Net Weight	370 g (0.82 lb)
Shipping Box	147x130x82 mm (5.79x5.12x3.23 in)
Shipping Weight	450 g (0.99 lb)

TECHNICAL PARAMETERS

Nominal Impedance	8 ohm
Minimum Impedance	6.6 ohm
AES Power Handling *	30 W
Maximum Power Handling **	60 W
Minimum Crossover Frequency ***	2.6 kHz
Sensitivity (1W/1m) ****	107 dB
Frequency Range	1.8÷20 kHz
Voice Coil Diameter	26 mm (1.02 in)
Winding Material	Copper Clad Aluminium
Former Material	Kapton
Diaphragm Material	Ketone Polymer
Diaphragm Shape	Dome
Winding Depth	1.7 mm (0.07 in)
Magnetic Gap Depth	2 mm (0.08 in)
Flux Density	1.3 T
Re	6 ohm
Phase Plug Design	Annular

NOTES

Driver mounted on a 1" 50° x 40° horn

Ferrofluid added in air gap

(*) Test made for 2 hours with Pink Noise signal (6 dB Crest Factor) from minimum crossover frequency. Power calculated on rated minimum impedance. Driver mounted on aluminium horn.

(**) Maximum power is defined as 3dB greater than nominal power.

(****) 12 dB/oct or higher slope high-pass filter

(****) Averaged within the frequency range

CURVES

