

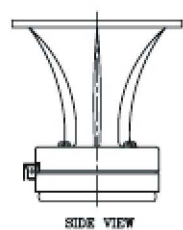

## Specifications

Diaphragm Diameter	1.0 inch (25.4mm)
Nominal Impedance	8 Ohm
Voice Coil DC Resistance	7.2 Ohm
Power Handling	20 Watt
Sound Pressure Level (1W@1M)	105 dB
Magnet	Ferrite
Diaphragm Material	Phenolic Resin
Horn Material	A.B.S With Glass Filled Black Polycarbonate
Nominal Coverage Angle -6 dB	80°
Cutoff frequency	2 kHz
Baffle cutout dimension	Ø 90 mm Ø 3.54"
Net Weight	0.88kg (1.93 lbs)
Shipping Weight	0.99kg (2.12 lbs)

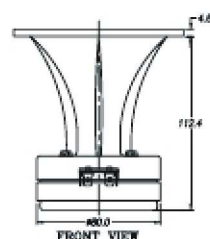
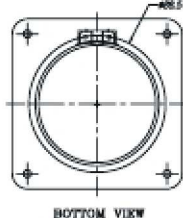
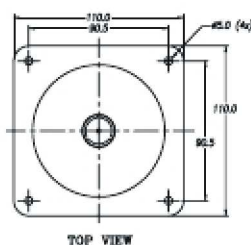

## Applications

### PHT-410

The PHT-410 is a high output high frequency integrated horn and driver. The driver is operating in a true compression mode. The horn is a small format square design that allows the PHT-410 to be used in very small enclosure designs. The PHT-410 is an excellent choice for two way designs where the low frequency transducer is an 8 inch or 10 inch loudspeaker. The PHT-410 features a sensitivity rating of 105dB with a one watt input, measured at one meter. This high sensitivity make the integrated horn/driver a very good device when used in applications where high acoustic output is specified but the overall loudspeaker system must be very small. Applications include retail spaces, pub back-ground systems and restaurant designs.

The physical mouth of the horn is a 4.3 inch (110mm) square design but the acoustic geometry is circular. This allows the PHT-410 to radiate a symmetrical pattern in both its horizontal and vertical axis. The PHT-410 is constructed from a very rugged glass reinforced ABS resin that offers both a high degree of structural support but also excellent mechanical damping for the device.

