

15" - 200W Ceramic Guitar Loudspeaker

C 15 K - 4 Ω

Code ZJ07112

GENERAL CHARACTERISTICS

Nominal Overall Diameter	385	mm
Nominal Voice Coil Diameter	50	mm
Magnet Weight	1450	g
Flux Density	1.15	T
Weight	5.28	Kg

THIELE-SMALL PARAMETERS

Voice Coil DC Resistance	R_E	3.17	Ω
Resonance Frequency	f_s	74.4	Hz
Mechanical Q Factor	Q_{MS}	9.58	
Electrical Q Factor	Q_{ES}	0.68	
Total Q Factor	Q_{TS}	0.63	
Mechanical Moving Mass	M_{MS}	57.4	g
Mechanical Compliance	C_{MS}	80	μm/N
Force Factor	$B \times l$	11.18	Wb/m
Equivalent Acoustic Volume	V_{AS}	64.2	lt.
Maximum Linear Displacement ...	X_{MAX}	+/-1.5	mm
Reference Efficiency	η_0	3.74	%
Diaphragm Area	S_D	754.8	cm ²
Losses Electrical Resistance	R_{ES}	44.6	Ω
Voice Coil Inductance @ 1kHz	L_E	0.58	mH

CONSTRUCTIVE CHARACTERISTICS

Magnet	Ferrite
Voice Coil Winding	Copper
Voice Coil Former	Kapton
Cone	Paper
Surround	Paper - Integrated
Dust Dome	Non Treated Cloth
Basket	Pressed Sheet Steel

ELECTRICAL CHARACTERISTICS

Nominal Impedance	4	Ω
Musical Power	200	W
Rated Power*	100	W
Sensitivity @ 1 W, 1 m	98.9	dB

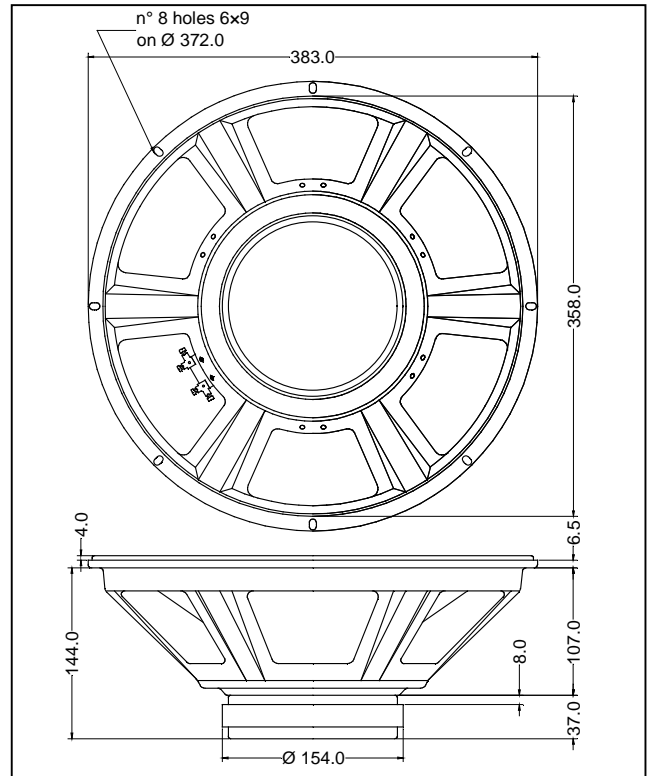

*rated power measured with 2 hours test with pink noise signal, 6 dB crest factor, loudspeaker mounted on enclosure
Thiele-Small parameters measured with LASER system

Frequency Response on IEC Baffle (DIN 45575) @ 1 W, 1 m - Free Air Impedance

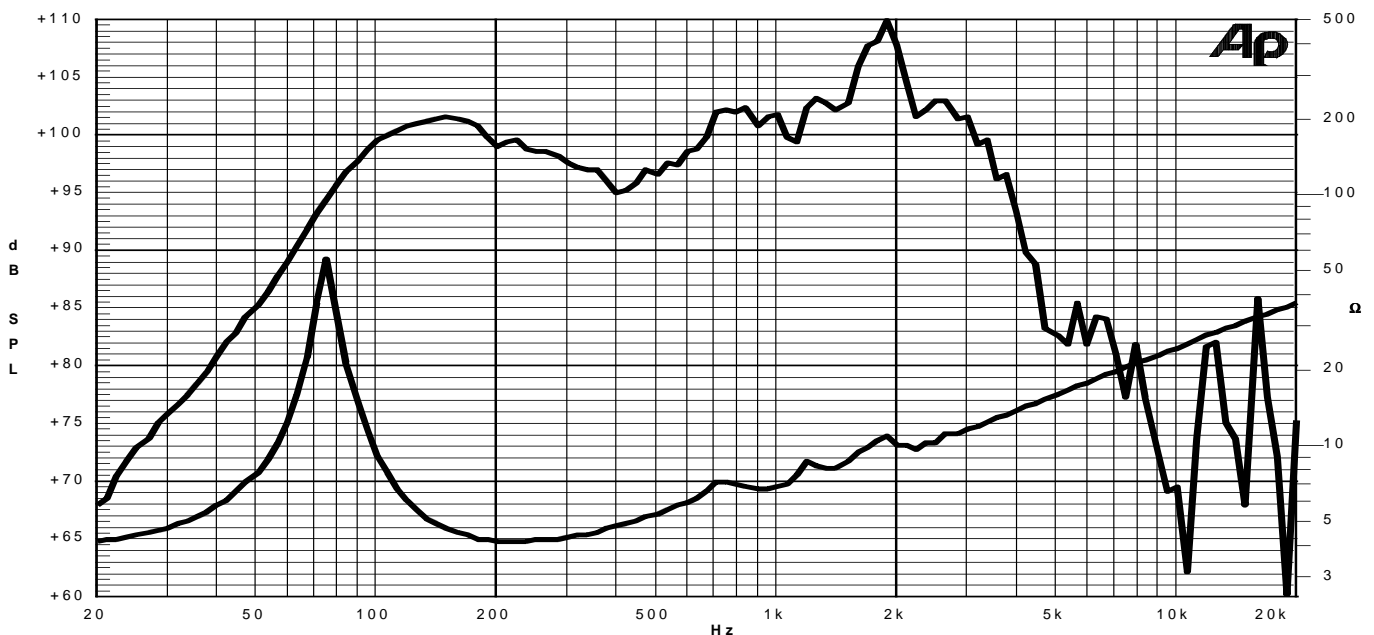

Due to continuing product improvement, the features and the design are subject to change without notice.

29/03/13